

HiQCH2 Specification Summary	
Weight:	360g / 12.7oz
Height:	58mm / 2¼"
Length:	180mm / 7"
Width:	122mm / 5"
Mating Connector:	5-blade standard battery connector
Communications Complies.	System Management Bus Rev 1.0, Smart Battery Data Specification rev 1.0 and Smart Battery Charger specification Rev 1.0 compliant
Power Supply	90-260VAC, 24V, 2.5A DC, 119x38x60mm, 500g / 18oz UL listed, CE Compliant, CEC Compliant
Mains Cord	110V N. American 3-pin connector 220V European 2-pin connector with ground recess 240V UK 3-pin connector

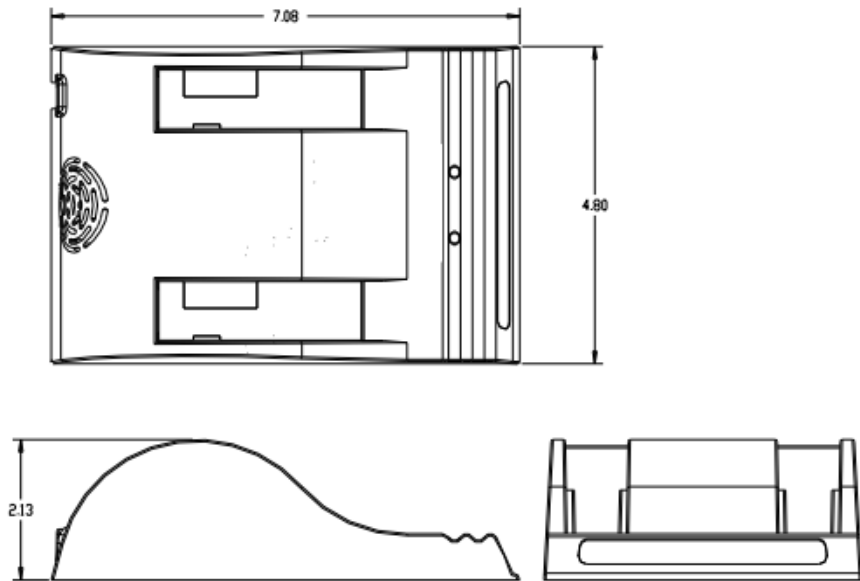

Remote Audio

220 Great Circle Road, Suite 114 Nashville, TN 37228

615.256.3513

HiQCH2

Simultaneous Smart
Charger+Calibrator



The HiQCH2 is a standalone dual bay, simultaneous desktop smart, standard battery charger with the added ability to recharge or recalibrate the fuel gauge on two smart battery packs at the same time. It works with all Inspired Energy® brand “N-Series” smart standard packs and hybrids irrespective of size, shape, voltage, cell chemistry or capacity.

What's in the box?

1. One HiQCH2 dual bay desktop charger/calibrator unit
2. Two sets of three plastic spacers to modify the battery bays to suit your battery size
3. One 24V 2.5A DC power supply with universal mains input
4. One mains cable.

North American chargers (HiQCH2A) are packed with a US 3-pin mains cord
European chargers (HiQCH2E) are packed with a European 2-pin mains cord
UK chargers (HiQCH2U) are packed with a UK 3-pin mains cord

Safety

1. Do not expose the charger or power supply to water or liquids; the case is not sealed.
2. Do not open the charger or power supply case; no user serviceable parts are inside.
3. Do not cover the fan exhaust or obstruct the airflow, this will cause overheating.
4. Use only the manufacturer's power supply and observe terminal polarity.
5. Place the charger in a cool spot, away from external heat sources
6. Caution - during recalibration the charger may become warm.